



Tranquil Waters

BEACHFRONT RETIREMENT

# The Pandora - Villa 84

- Two Bedrooms • Lockup Garage
- Ensuite & Bathroom • Independent Living Villa

Floor Area 127.42m<sup>2</sup> (13.71sq)

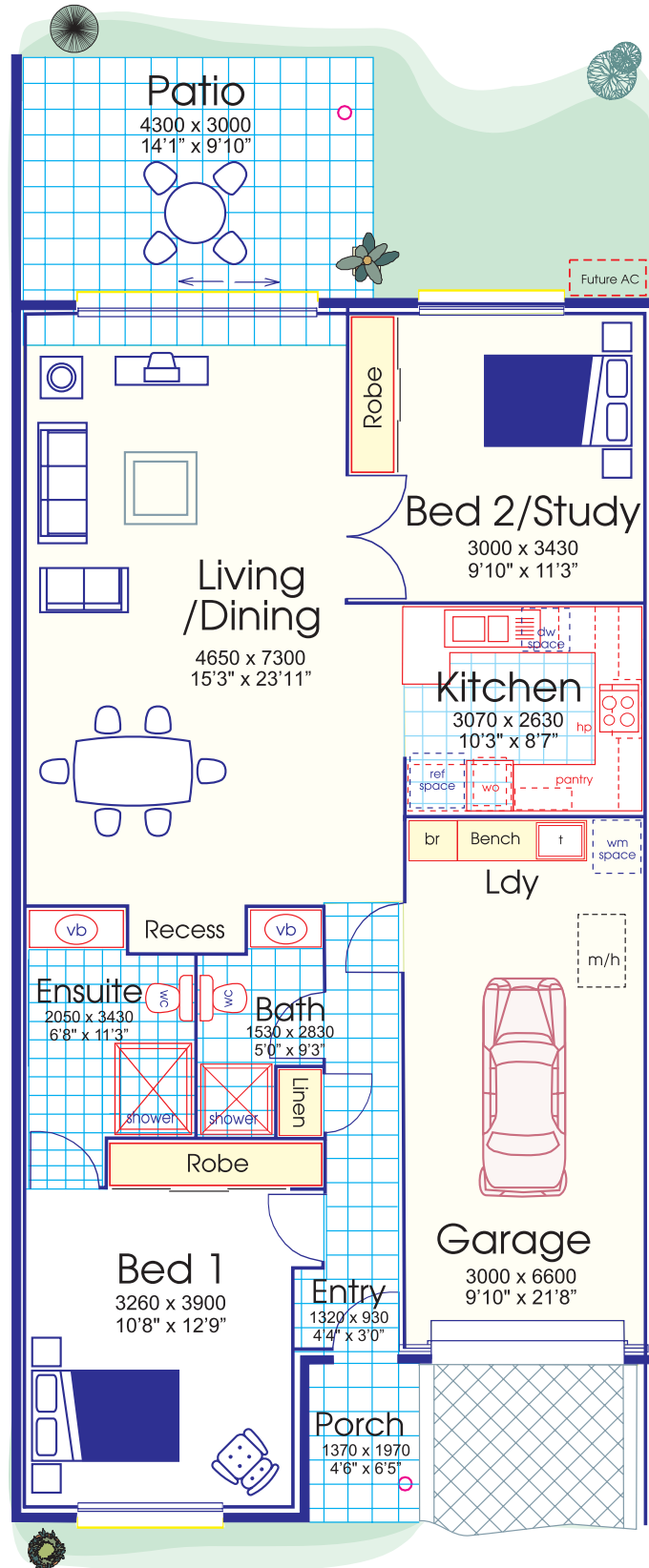



# Tranquil Waters

BEACHFRONT RETIREMENT

## The Pandora - Villa 84

- Two Bedrooms • Lockup Garage
  - Ensuite & Bathroom • Independent Living Villa
- Floor Area 127.42m<sup>2</sup> (13.71sq)

### Bedroom 1

- Variable speed ceiling fan
- Built-in robe, shelves
- Superior quality carpet
- Telephone socket
- Television point and power points

### Ensuite

- Vanity unit and basin
- Shower with quality flexible hand set
- Powder coated shower screen
- Wall mounted mirror
- Quality finished flick mixer taps
- Exhaust fan and heater light
- Power point
- WC with adjacent grab rail

### Bedroom 2 / Study

- Ceiling fan
- Built-in robe, shelves
- Superior quality carpet
- Power points

### Bathroom

- Vanity unit and basin
- Shower with quality flexible hand set
- Powder coated shower screen
- Wall mounted mirror
- Quality finished flick mixer taps
- Exhaust fan and heater light
- Power point
- WC with adjacent grab rail

### Living / Dining

- Variable speed ceiling fan
- Superior quality carpet
- Telephone socket
- Television socket

### Patio and Porch

- Ceramic floor tiles to porch
- Ceramic floor tiles to patio
- Ceiling lights
- Weatherproof power point

### Kitchen

- Caesar stone benchtop
- Stainless one & half bowl steel sink with quality tap
- Pantry cupboard, many drawers
- Dishwasher drawer
- Quality wall oven and hot plates
- Quality floor tiles
- Down light over sink area
- Slim-line exhaust fan
- Microwave position
- Television point and power points

### Laundry

- Stainless steel wash tub
- Bench and cupboards
- Ceramic floor tiles & tiles to splashback

### Garage

- Lock up panel lift door with remote control and internal access
- Power point
- Fluorescent light

### Site Landscaping

- Intensive landscaping to front and all areas
- Fold-down clothes line
- Two hose taps

### General Items

- Emergency call system button
- All walls & ceilings with quality paint
- Sliding powder coated aluminium windows
- Doors, architraves and skirting with gloss enamel paint finish
- All windows key locked
- Quality internal doors
- Smoke detector-mains plus battery back-up
- Wired & plumbed for air conditioning
- Security screens
- Front door with glass infill
- Gas hot water service
- 3000 litre rain water tank

### Store / Linen

